

Geberit Home App

Operating the shower toilet using the app

You can execute the following functions and settings via the Geberit Home App:

- using remote control functions
- adjusting and saving basic settings
- contacting Geberit Customer Service
- registering devices and extending warranty services
- updating the firmware

You can call up the following information via the Geberit Home App:

- step-by-step instructions on maintenance, descaling and cleaning
- explanatory videos on maintenance, descaling and cleaning
- error messages
- user manuals

The Geberit Home app is available free of charge for Android and iOS smartphones in the respective app stores.

iOS:



Android:



■ GEBERIT

GEBERIT AQUACLEAN TUMA COMFORT QUICK GUIDE



What you need for cleaning

Selecting suitable cleaning agents and cleaning equipment

The Geberit AquaClean cleaning set (art. no. 242.547.00.1) includes a ready-made cleaning agent that is optimal for cleaning all Geberit AquaClean surfaces.



CAUTION

- Cleaning with aggressive descaling and cleaning agents
Aggressive descaling and cleaning agents can cause surface damage.
- Only use Geberit AquaClean descaling agent in the device.
 - Only use cleaning agents permitted by Geberit.

Geberit AquaClean consumables



Geberit AquaClean cleaning set (art. no. 242.547.00.1)



Geberit AquaClean descaling agent (art. no. 147.040.00.1)

Permissible cleaning agents



Only skin-friendly cleaning agents



Only liquid cleaning agents



Preferably water-diluted cleaning agents



Cleaning agents with a low acid content (e.g. diluted citric acid)



Low-foaming cleaning agents

Permissible cleaning equipment



Soft, fine-pored sponges



Lint-free, soft cloths which are free of dust



Toilet brush

■ GEBERIT

7384952587 © 02.2021
967.280.00.0(02)

Getting to know your device

The device at a glance

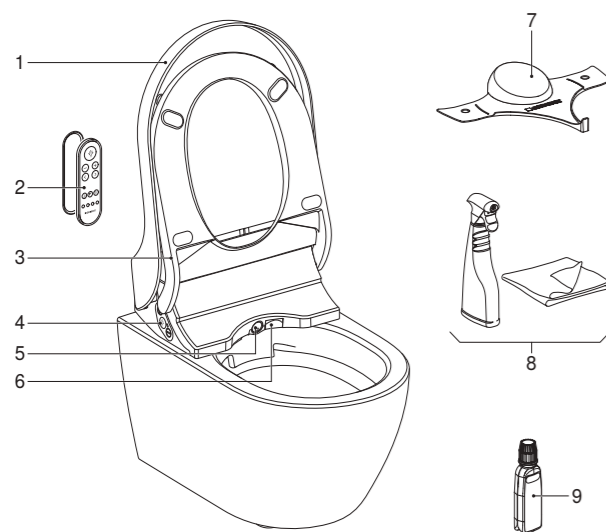

- 1 WC lid
- 2 Remote control with magnetic wall-mounted holder
- 3 WC seat ring with user recognition and WC seat heating
- 4 Lateral control panel with status LEDs
- 5 Spray arm with spray nozzle and Lady shower nozzle
- 6 Dryer flap
- 7 Spray shield
- 8 Geberit AquaClean cleaning set (art. no. 242.547.00.1)
- 9 Geberit AquaClean descaling agent (art. no. 147.040.00.1)

Lateral control panel

The shower toilet functions of the device can be operated from the lateral control panel.

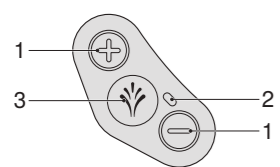

- 1 <->/<+> button: increase or decrease the spray intensity
- 2 Status LED
- 3 <Shower> button: start or stop the anal shower or the Lady shower

Front side of the remote control

The shower toilet functions can be operated with the remote control.

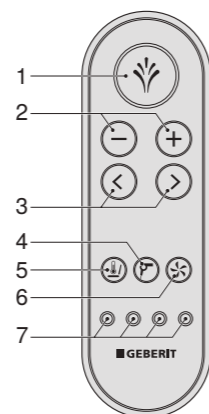

- 1 <Shower> button: start and stop the spray functionality/stop dryer functionality
- 2 <->/<+> buttons: decrease or increase the spray intensity
- 3 <left>/<right> arrow keys: set the spray arm position
- 4 <Dryer> button: start and stop the dryer
- 5 <WC seat heating> button: switch WC seat heating on/off
- 6 <Odour extraction> button: start and stop odour extraction
- 7 User profile buttons: activate the user profiles 1–4.

i User profiles allow you to access your personal settings directly. You can save 4 user profiles.

Re-assign remote control

i The device can only be operated with a single, assigned remote control.

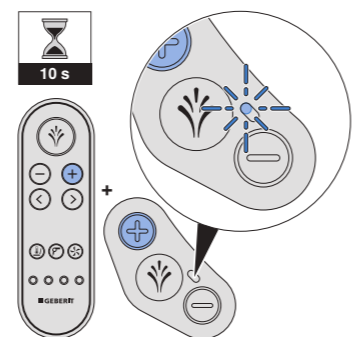

▶ Press the <+> button on the remote control and the <+> button on the lateral control panel for approx. 10 seconds.

Result

- ✓ The device beeps (1x) and the blue status LED on the lateral control panel lights up for 4 seconds.
- ✓ The shower toilet can be controlled by remote control.

How to use the device

Using the anal shower

Briefly press the <Shower> button on the lateral control panel or on the remote control once.

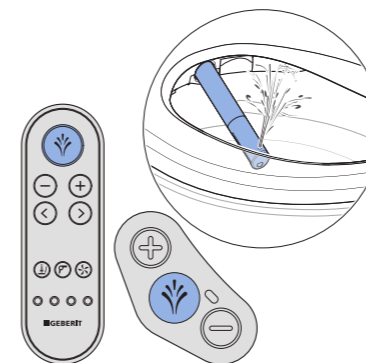

i You can stop the shower procedure early by pressing the <Shower> button once again.

Using the Lady shower

Press the <Shower> button on the lateral control panel or on the remote control for 2 seconds.

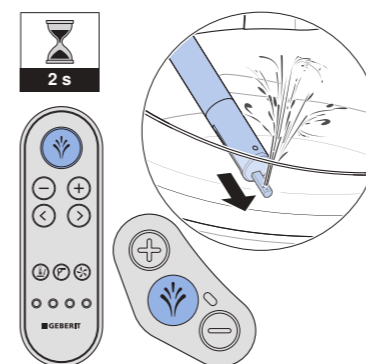

i You can stop the shower procedure early by pressing the <Shower> button once again.

Set the spray intensity

Press the <+> button to increase the spray intensity.
Press the <-> button to decrease the spray intensity.

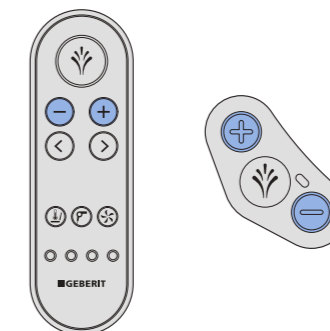

i You can set the spray intensity in 5 stages.

Set the spray arm position

Press the arrow keys on the remote control to position the spray arm.

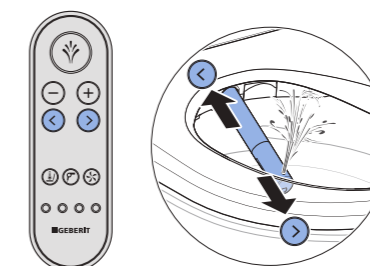

Deactivate the oscillating motion of the anal shower

Briefly press the <left> and <right> arrow keys on the remote control at the same time.

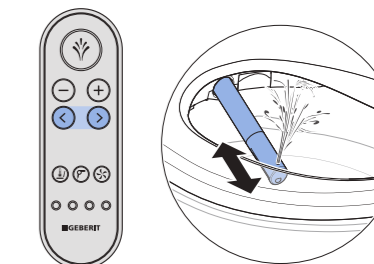

i By pressing the buttons again for 2 seconds, you can reactivate the function.

Using the dryer

Stop the drying procedure.

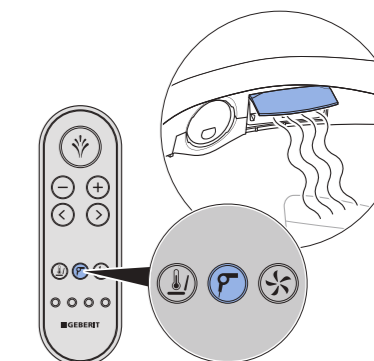

i The dryer functionality can be started during a shower procedure using the <Dryer> button.
The drying procedure interrupts the spray functionality.